

CERTIFIED RECORD OF LAND CORNER MONUMENTATION

History of original corner establishment:

not previously established

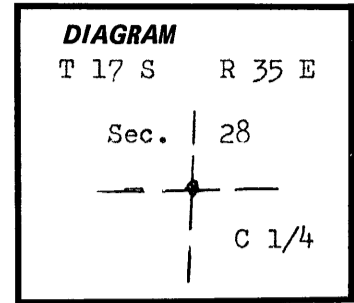

Description of corner evidence found:

A blazed line just north of true corner location runs East and West. This line run by Bert Udell (no date).

Description of monument and accessories I established to perpetuate the original location of this corner:

At the established corner location I set a standard F. S. monument consisting of a 3" disk mounted on a 2 1/2 x 30" pipe with a 4 x 4 1/2" footplate, buried 24 inches with 6 inches protruding above the ground. Disk on the monument is stamped as shown. Witnessed by P. Zabala and S. Moss.

New BT's established :-

- a 7" douglas Fir bears S. 13° W., 18.0 ft distant, scribed C 1/4 S 28 BT
- a 10" Lodgepole Pine bears N. 67°50' W., 20.9 ft distant scribed C 1/4 S 28 BT

Both BT's are banded with red paint, carry BT and Attention signs and have a brass disk stamped PLS 1287 nailed to the base of the BT blaze.

Steel fence posts with boundary signs lie 3 feet East and 3 feet West of the corner monument.

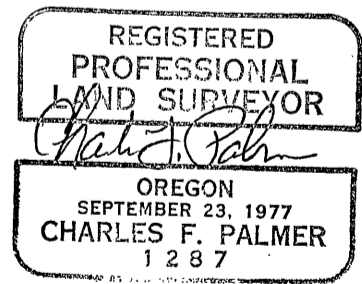
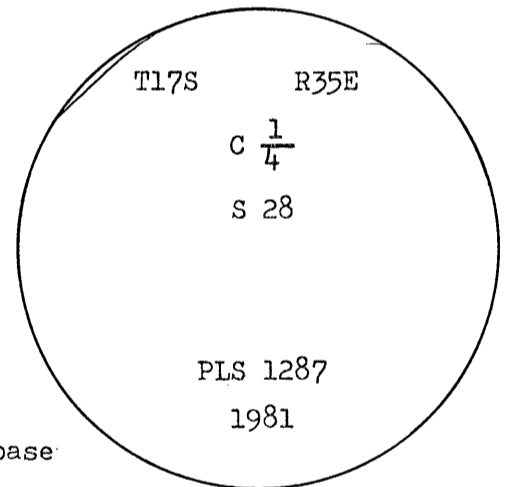

Office of Surveyors County of Grant
 State of Oregon, I hereby certify that the within instrument was filed in this office
 for record on the 23 day of Nov, 1982
Robert D. Dugitt by _____
 (COUNTY OFFICIAL) (DEPUTY)